

Have Home Depot or Lowes Cut for you

1 x 2 x 96" (Qty 4)

Step 1: Assemble Sides (Qty 2)

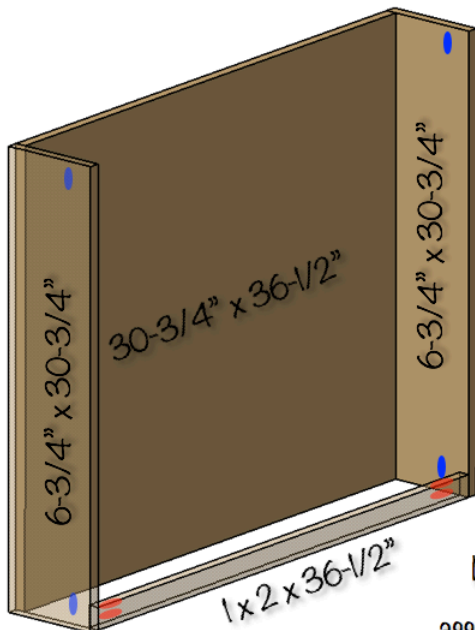

Drill pocket holes as shown and assemble using $1\text{-}1/4"$ pocket screws.

Also, drill pocket holes as shown for future steps.

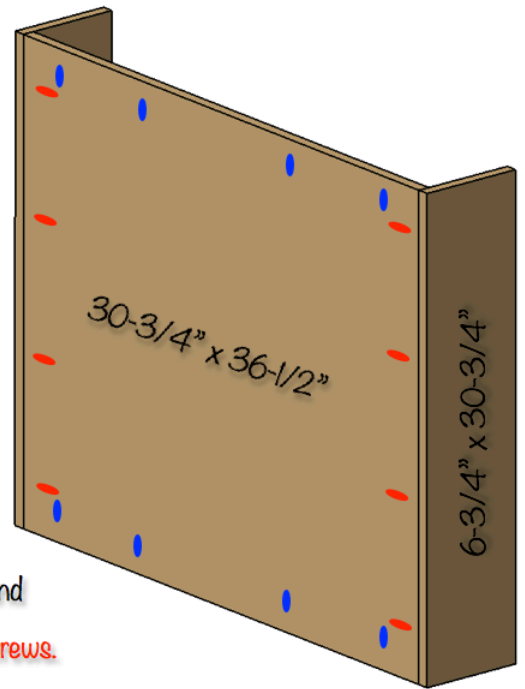

Step 2: Assemble Base

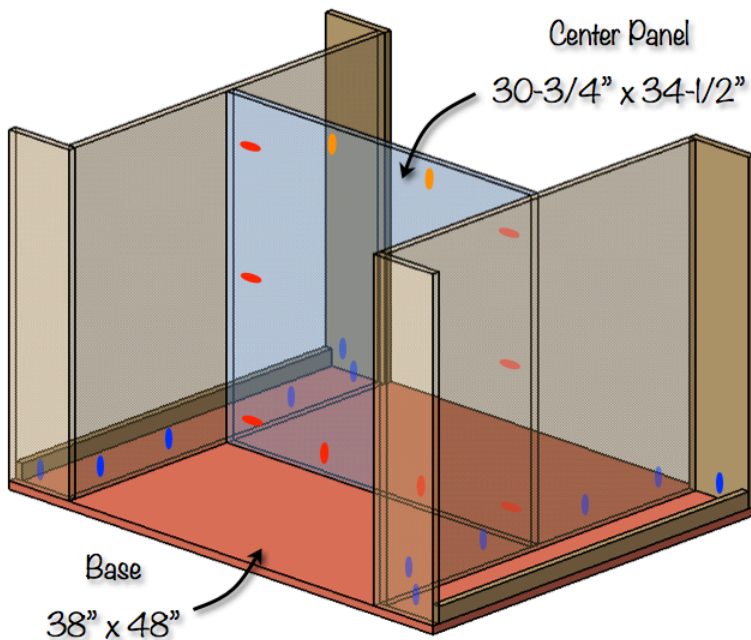

Drill pocket holes as shown in the center panel. Utilizing pre-existing holes, assemble using $1\text{-}1/4"$ pocket screws.

Also drill pocket holes for future steps.

Step 3: Attach Top

Utilizing pre-existing holes, attach top using 1-1/4" pocket screws.

Also, now is a good time to install the swivel casters.

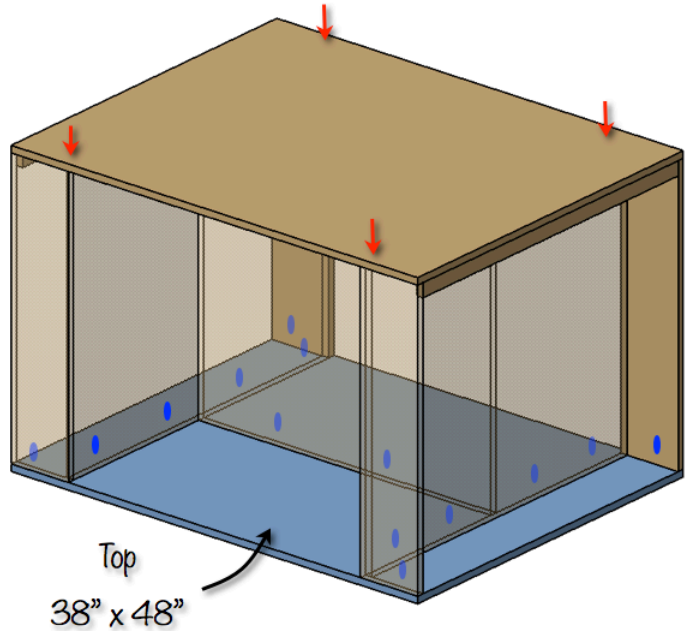

Step 4: Assemble Shelves (Qty 6)

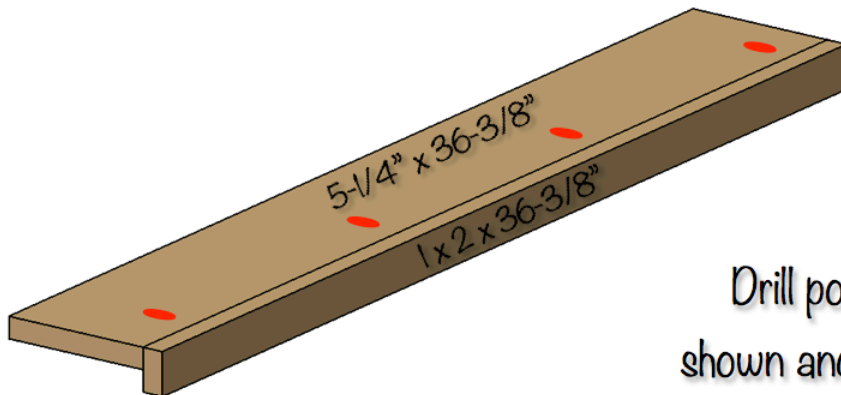

Drill pocket holes as shown and assemble using 1-1/4" pocket screws.

Step 5: Install Adjustable Shelves

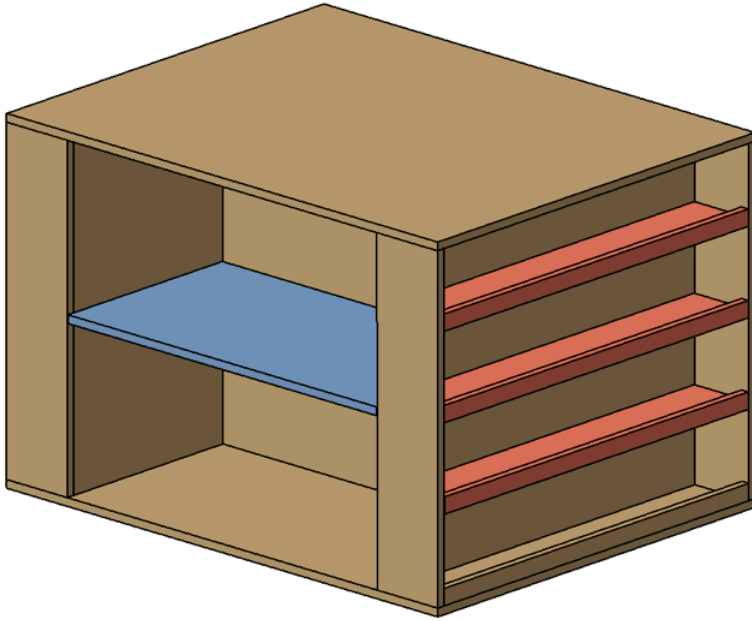

Using your Kreg shelf pin jig, drill your 5mm shelf pin holes as shown in the pictures.

Install shelf pins and shelves at desired height.

Step 6: Install Rosin Roll

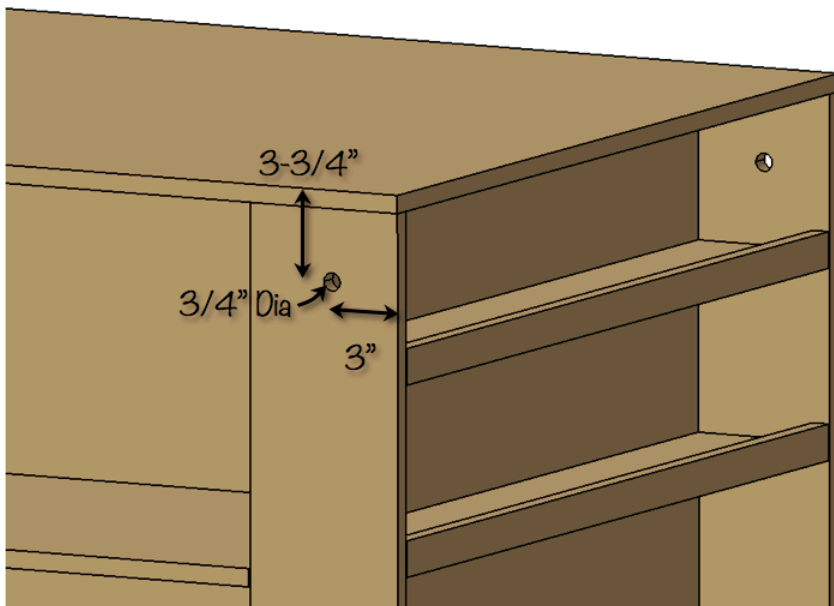

If you would like to install a roll of Rosin paper to protect your work surface as I have, you will need to drill a 3/4" hole as shown to accept the rod.

Then screw in a "keeper" to cover the holes and be rotated out of the way for swapping out rosin rolls. I used two 1/4" x 2" x 3-1/2" pieces of oak.